

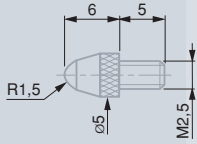

Measuring Inserts for Dial Gauges, Axial Probes and other Hand-Held Tools

Executions with a M2,5 coupling thread



Standard spherical measuring inserts.

No		L mm
03510001	Steel	6
03510002	Carbide	6
03560001	Sapphire	6

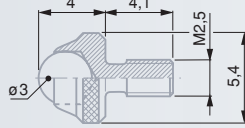

Short spherical measuring insert.

No		L mm
03560007	Carbide	4

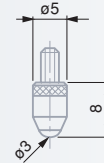

Long spherical measuring inserts.

No		L mm
03560019	Steel	8
03560020	Carbide	8
03560021	Sapphire	8

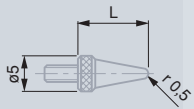

Spherical measuring inserts,
R = 0,5 mm.

No		L mm
03560035	Steel	5
03560036	Steel	10
03560037	Steel	15
03560038	Steel	20
03560039	Steel	30
03560040	Steel	40

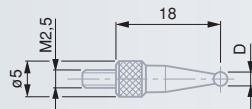

Spherical measuring inserts.

No		mm
03560051	Carbide	1
03560052	Carbide	2
03560053	Carbide	3
03560054	Carbide	4
03560055	Carbide	5
03560056	Carbide	6
03560057	Carbide	7
03560058	Carbide	8
03560059	Carbide	9
03560060	Steel	10
03560061	Steel	11
03560062	Steel	12

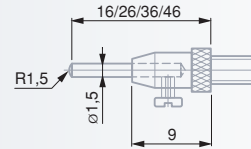

Spherical measuring insert with
4 interchangeable pins, R = 1,5 mm.

No		L mm
03510201	Steel	16, 26, 36, 46

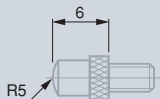

Spherical measuring inserts.

No		R mm
03510101	Steel	5
03510102	Carbide	5

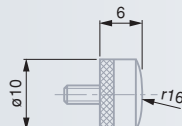

Spherical measuring inserts

No		R mm
03560017	Steel	16
03560018	Carbide	16

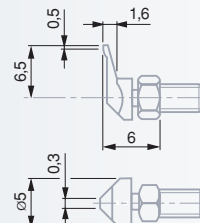

Measuring insert with offset (A)
contact point and lock nut for radial
alignment.

No		A mm
03510401	Steel	6,5



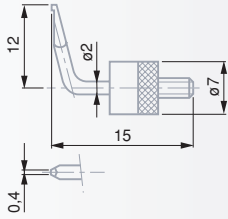

Measuring insert with offset (A) contact point and lock nut for radial alignment.

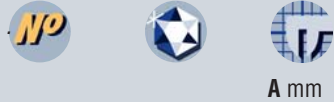

03560063 Steel 12

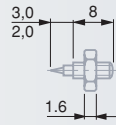

Insert with needle contact point.

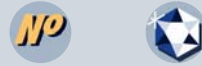

03560030 Steel

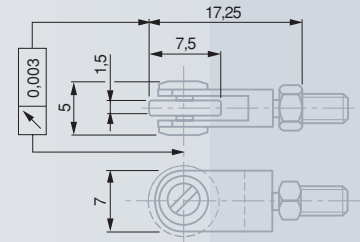

Measuring inserts with ball-bearing rollers. Lock nut for radial alignment.



03560010 Steel cylindrical
03560011 Steel ball-shaped

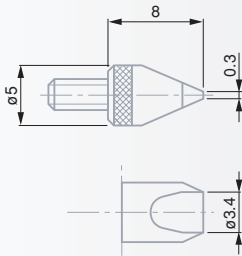

Measuring inserts with blade-shaped measuring face. Lock nut for radial alignment

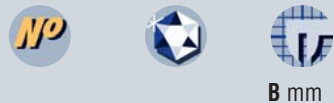

03560024 Steel 0,3
03560025 Carbide 0,3

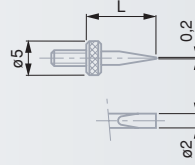

Measuring inserts with blade-shaped measuring face, in steel. Lock nut for radial alignment.

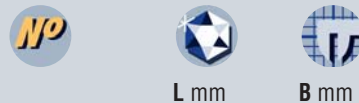

03560031 5 0,2
03560032 10 0,2
03560033 15 0,2
03560034 20 0,2

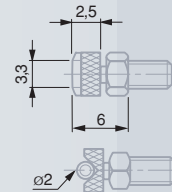

Insert with a cylindrical measuring face. Lock nut for radial alignment.

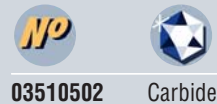

03510502 Carbide

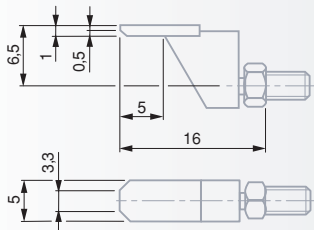

Insert with narrow, off-centre measuring face. Lock nut for radial alignment.



03510602 Carbide 0,5

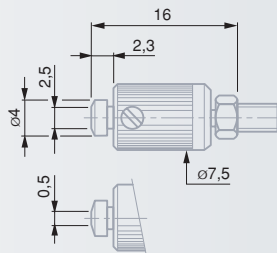

Insert with a narrow, parallel adjustable measuring face. Lock nut for radial alignment.



03510702 Carbide 0,5

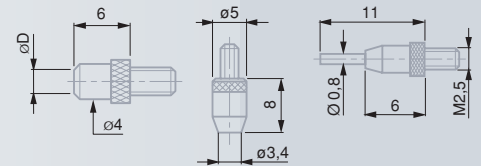

Inserts with a flat measuring face.



03510801 Steel 2,5
03510802 Carbide 2,5
03560022 Steel 3,4
03560023 Carbide 3,4
03560081 Carbide 0,8

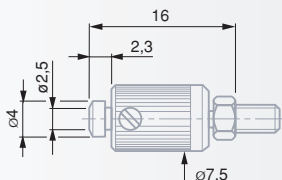

Measuring insert with a flat, parallel adjustable measuring face. Lock nut for radial alignment.



03510902 Carbide 2,5

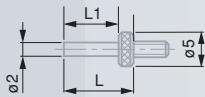

Steel inserts with a flat measuring face.

Nº	L mm	L1 mm	mm
03560026	5	2,8	2
03560027	10	7,8	2
03560028	15	12,8	2
03560029	20	17,8	2

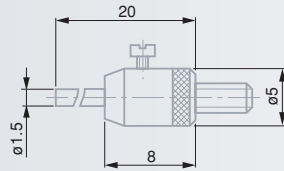

Inserts with a flat measuring face as well as interchangeable pin.

Nº	Material	mm
03560008	Steel	1,5
03560009	Carbide	1,5

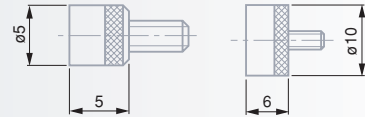

Inserts with a flat measuring face.

Nº	Material	mm
03560012	Steel	5
03560013	Carbide	5
03560014	Steel	10
03560015	Carbide	10
03560016	Steel	20

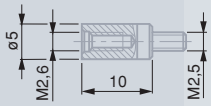
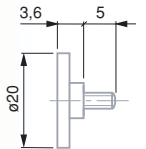

Connectors for measuring inserts.

Nº	Inside	Outside
03560066	M2,5	M2,6
03560067	M2,5	M3
03560064	M2,6	M2,5
03560065	M3	M2,5
03560068	M2,5	6BA
03560069	M2,5	8BA
03560070	6BA	M2,5
03560071	8BA	M2,5

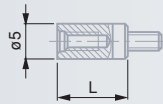

Extensions for measuring inserts.

Nº	L mm
03560042	10
03560043	15
03560044	20
03560045	25
03560046	30
03560047	35
03560048	40
03560049	45
03560050	50

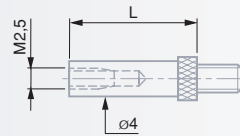

Extensions for measuring inserts.

Nº	L mm
03540501	10
03540502	15
03540503	20
03540504	40

Executions with a M2 Coupling Thread

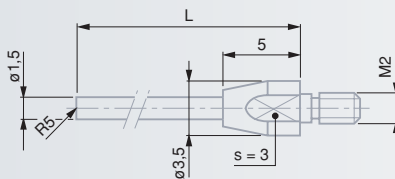
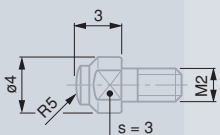
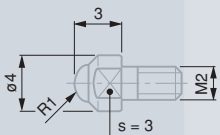

Spherical measuring inserts, R = 5 mm. M2 thread.

Nº	Material	L mm
03510202	Carbide	16
03510203	Carbide	26

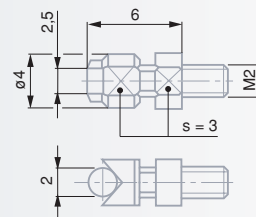

Measuring insert with cylindrical measuring face. Lock nut for radial alignment. M2 thread.

Nº	Material
03510503	Carbide

Spherical measuring inserts, M2 thread.

Nº	Material	R mm
03510204	Carbide	R 1
03510103	Carbide	R 5

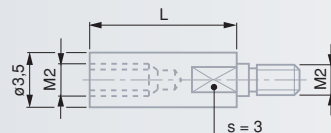

Extensions for measuring inserts, M2.

Nº	L mm
03540505	10
03540506	15

Devices for Plunger Retraction



Top mounted retraction devices.

N ^o	=	
03560004	Retraction device	mm Ø 40
03560005	Retraction device	Ø 58

Each consisting of:

- Lift lever
- Head screw



Bottom mounted retraction device.

N ^o	=	
03540104	Retraction device	

Consisting of:

03540101	Lift lever
03540102	Washer



Bottom mounted lift lever.

N ^o	
01960005	



90° Angle Probe



N ^o	=	
03560006	90° angle probe used for the transmission of the plunger movement up to 10 mm. Suited for dial gauges with a 0,01 mm scale division.	

Furnished with:

03560012	Measuring insert with a 5 mm diameter flat face
----------	---





A Dull-chrome plated, except for models
No. 01460010, 01460011, 01460016 and 01460017

H Holding force = 150 N

Backs for TESA YR and MERCER Precision Dial Gauges in Standard or TOP Quality Version

Executions for dial gauges with a 40 mm dial diameter



01460008	A	Back with central lug
01460009	B	Back with offset lug
01460010	C	Back with a 8 mm dia. fixing shank
01460011	D	Back with M6 inner thread
01460012	E	Back with permanent magnet

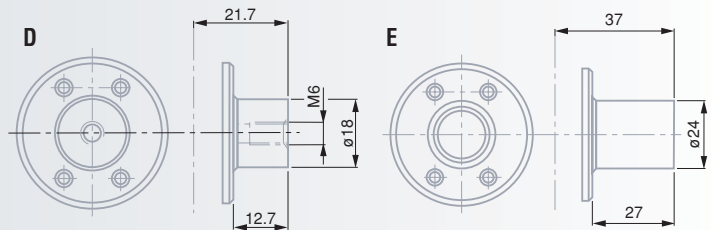
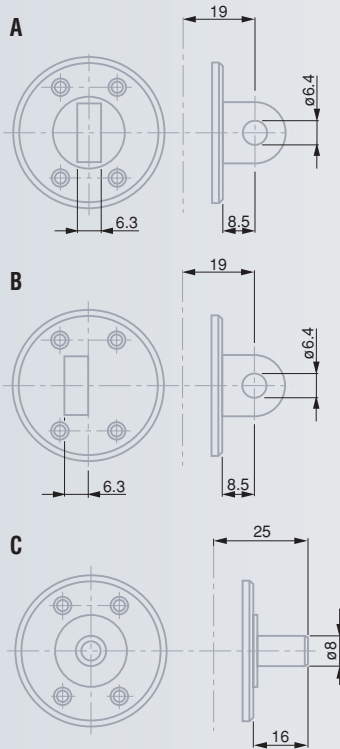

Executions for dial gauges with a 58 or 82 mm dial diameter



01460013	A	Flat back
01460014	B	Flat back with central lug
01460015	C	Flat back with offset lug
01460016	D	Back with a 8 mm dia. fixing shank
01460017	E	Back with a M6 inner thread
01460018	F	Back with 4 clamping bores as per CNOMO French standard
01460019	G	Back with permanent magnet

