



## 0715 Dial test indicators



0715 101



0715 201

### Model

- Carbide tipped measuring inserts, Ø 2.0 mm
- Form A in accordance to DIN 2270
- Revolving dial
- 3-piece swallow tail guide
- Automatic reversal of the counting direction
- Measuring force 0.15 N

### Delivery

- Fitted case

**DIN**  
**2270**

⊗	☒	Measuring range mm	Scale graduation value mm	Range per rev. mm	Stylus length mm	Dial reading	Outer ring (Bezel) Ø mm	Order no.	List price EUR
		± 0.4	0.01	0.8	14.5	0-40-0	30	0715 101	80.00
		± 0.4	0.01	0.8	14.5	0-40-0	40.5	0715 103	90.00
		± 0.25	0.01	0.5	41.2	0-25-0	30	0715 201	126.00
		± 0.1	0.002	0.2	14.5	0-100-0	40.5	0715 303	113.00
		± 0.1	0.002	0.2	14.5	0-100-0	30	0715 305	107.00
		± 0.5	0.01	0.5	32.3	0-50-0	40.5	0715 307	160.00

## 0715 Clamping shanks for dial test indicators

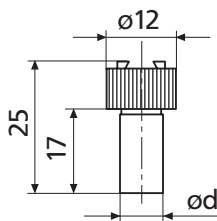

### Model

- With swallow tail mounting for dial test indicators and clamping nut

⊗	☒	Diameter	Order no.	List price EUR
		4h6	0715 903	12.10
		8h6	0715 907	12.10

## 0715 Measuring inserts with carbide ball

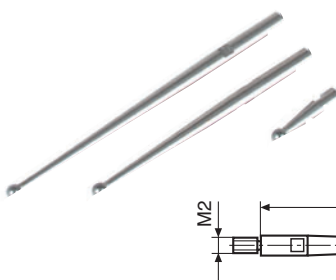

⊗	☒	Length mm	Ball diameter mm	Order no.	List price EUR
		14.5	1	0715 915	16.90
		14.5	2	0715 917	13.30
		14.5	3	0715 919	13.30
		32.3	1	0715 921	18.70
		32.3	2	0715 922	14.10
		32.3	3	0715 923	14.00
		41.2	1	0715 925	17.10
		41.2	2	0715 926	13.30
		41.2	3	0715 929	13.30



## 0715 Key for measuring inserts



		Order no.	List price EUR
		0715 940	2.50

## 0715 Universal clamp

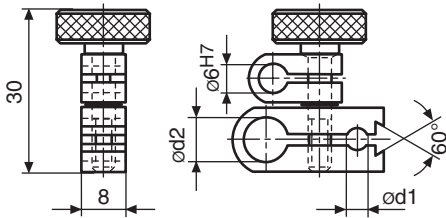

		Diameter mm	Order no.	List price EUR
		8	0715 950	25.30

## 0715 Holder

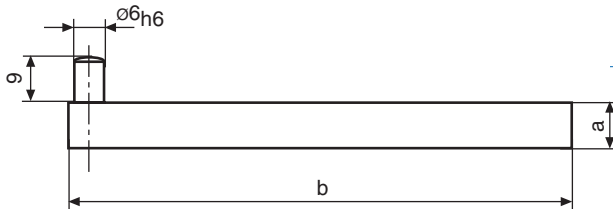

		Length mm	Cross-section mm	Order no.	List price EUR
		100	9 x 9	0715 955	16.00